



1100 State Street ~ Ogdensburg, NY 13669

www.ILoveTheatre.org

[www.Facebook.com/OgdensburgCommandPerformances](https://www.facebook.com/OgdensburgCommandPerformances)

V: 315-393-2625 ~ F: 315-393-3745 ~ E: ocp@ogdensburgk12.org

II. TECHNICAL INFORMATION

A. George Hall Auditorium (Diagram 1)

1. **Dimensions:** Depth: 75' (edge of stage to last row of seats) x Width: 80'

2. **Capacity:** 927 (Main Floor 736 + Balcony 191)

3. Ticket Scale

- a. Orchestra 1 - 259 seats
 - Single Tickets - \$37
 - 5 show Season Ticket - \$158
- b. Orchestra 2 - 282 seats
 - Single Tickets - \$31
 - 5 show Season Ticket - \$131
- c. Orchestra 3 & Lower Balcony - 201 seats
 - Single Tickets - \$26
 - 5 show Season Ticket - \$112
- d. Orchestra 4 & Upper balcony - 181 seats
 - Single Tickets - \$17
 - 5 show Season Ticket - \$68
- e. Obstructed - 4 seats
 - Single Tickets - \$8

10% Discount in all sections for donors/seniors/students/military

(The majority of the ticket buyers are seniors/donors who purchase Season Tickets)

B. Load-In Point:

1. **Exterior Door:** 7'4" W x 8'11" H (Street level)
2. **Loading Dock:** None - Ramp from truck (Stage is street level)
3. **Route:** Straight 35' from Door to Stage Left
4. **Trucks:** 2 Semi-trailers can back in 20' from the doors
5. **Motors Running:** Not during the school day

C. Parking: At the "Golden Dome" with shore power

D. Stage Crew: Non-Union

E. Equipment

1. **Genie Lift/ Ladder** - 40', 10 1/2'
2. **Pianos:** Yamaha baby grand, Hamilton upright
3. **Smoke/Haze:** Yes
4. **Projector:** 1 LCD
5. **Risers:** 18 - 24"h, 8 - 16"h, 8 - 8"h
6. **Tractor with forks** - Can lift 2000 pounds
7. **Elevator**

F. Back Stage Rooms (all with paging)

1. **Stage level** - Behind the crossover (6'w x 80'L)
 - a. 2 Principal Dressing Rooms: 8½' x 8½' connected to Chorus Rooms with folding door
 - b. 2 Chorus Dressing Rooms: 11 ½ x 15 ½ (Sinks/Showers/Toilets) connected to Principal Rooms with folding door
 - c. Stage Manager's Office: 8½' x 8½' (Could be DR)
 - d. Work Room: 17' x 17' with 1 Washer and Dryer, iron, ironing board, steamer
(2nd washer and dryer in basement could be available)

2. Stage Right

- a. Green Room: 10' x 12' - Foyer to Courtyard
- b. 2 Principal Dressing Rooms: 8½' x 8½' in music department (Sinks/Showers/Toilets nearby)

G. Equipment:

1. **Mirrors, Rolling Wardrobe Racks, Chairs – No lockers**
2. **Quick Change:** Can Be Setup with Clip Lights & Mirrors

H. Stage

1. Dimensions

- a. Proscenium Opening: 44' w x 20' h
- b. Stage: 36' 6"D (including apron) x 52'W x 48' 9"H (to underside of rigging steel)
 - Plaster Line to Back Wall: 30'
 - Plaster Line to Edge of Apron: 6' 6"
- c. Wing Space
 - SR: 12' Counterweight System
 - SL: 16'6" - Sound & Lighting tie-in panels on the wall
- d. Crossover – Behind the stage (80' x 6')

2. Entrances:

- a. Backstage to Stage
 - SL - Crossover: Single Door, Wings: Double Doors
 - SR - Crossover: Double Doors
- b. Stage to House
 - Apron: SL and SR
 - Center Stage: Risers can be set up for access to audience
- c. Hall to Crossover: Single Door SL and SR

3. Floor

- a. Masonite - Flat black - No traps or elevators
- b. Portable Dance Floor – Yes
- c. Lagging - Yes

4. Orchestra "Pit"

Dimensions:

- a. Stage to 1st row of seats: 10'
- b. Height: 3' house floor/audience level to stage - Cannot be raised or lowered
- c. Width: 44'

I. STAGE RIGGING SYSTEM (Attachment 2 – Stage Rigging System) (Diagram 2 - Stage Rigging & Drapery Plan)

1. **Type:** Single Purchase

2. **Location:** SR on stage floor

3. **Total Weight Available:** 15,000 pounds - Fall Protection System w/ harness required for loading/unloading the loading gallery

4. **Line set Schedule:** (Attachment 2 - Stage Rigging System)

- a. 31 - 3 motorized 2300 pounds capacity
28 manual counterweight 1300 pounds (1150 live)
- b. Size - Length: 54', Diameter: 1.5", Spacing 8"
- c. Line 5 – Projection Screen +4'6" – Cannot be used for anything else.

5. **Grid** – No walkable grid iron; system is underhung from roof steel

6. Pre-Hung Motors/Chain Hoists - (Diagram 3 - General Stage Plan)

The touring company is required to identify the point load locations/the location of the chain motor(s) and actual loading of each (2,000 lbs. or less) on the *General Stage Plan*. The heavier lines represent the rigging beams designed to support rigging loads of 42,000 pounds evenly distributed over the fly area. (The lighter lines represent the roof beams which are not designed to carry any additional loads.) With this information, the architects will be better able to reply. (It is difficult to hang chain hoists.)

7. Fly

- a. How High Will Lines Fly? 46'3"
- b. How Low Will Battens Fly? 4' from the stage floor

J. STAGE DRAPERIES

1. Act Curtain

- a. Line 1 - Grand Drape - Guillotine or manual traveler, controlled SR
- b. Ink Blue Velour, 27' x 22'

2. Legs (vertical) - 3 pair, Lines 4, 12, 23 - all on 15' traveler tracks

- a. Not permanently hung - Lines can be available, tracks do not come off
- b. Black Velour - New

3. Borders/Teasers (horizontal) - 4

- a. Not permanently hung - Normally on lines 2, 11, 16, and 22
- b. Black Velour - New, 54' x 8'

4. Backings /Travelers - 4 Guillotine or manual

- a. Mid-stage - Line 17, +13' 10"
- b. Rear - Line 29, +25' 8"

5. Cyclorama: Line 30 - 50' x 22' +26' 8" white

6. Side Tabs: 6 - 6' x 22' black

7. Scrim: 2 Black and white - 50' x 22'

K. STAGE LIGHTING SYSTEM - (Attachment 3 - Stage Lighting System)

(Diagram 4 - Stage Lighting System/House Fixture Plot)

1. Power Source: 400Amps

- a. Location: SL wall Power Panel Disconnect - Cam locks and bare tails
- b. House electrician: Only to gain access to the panel

2. Dimmer Racks

- a. Location: Electric Room off Crossover Hall
- b. Brand: ETC SensorD20 (1-158) ETC Sensor R20 (165-192)
- c. Type: Dimmer/Circuit
- d. Wattage Capacity: 2.4 kw each
- e. System was installed in 2015 - Excellent Condition, Very Reliable

3. Control

- a. Memory Board - ETC ION 1500 with 1536 outputs/parameters plus - New, Very Reliable
 - 2x20 Fader Wing
 - 2 Monitors - 19' ELO Touchscreen - DVI
- b. Location:
 - Lighting Booth in Balcony - 75' from Plaster line, app. 15 degree angle
 - Mid SL, DSL, Auditorium Center at sound board location under balcony
- c. Remote Control Station: One wireless hand held remote
- d. House Lights: Independent system operated back stage, sound board, or light booth

L. LIGHTING EQUIPMENT

1. Instrument Inventory: All have color frames and hardware

#	<u>Brand</u>	<u>Type</u>	<u>Focal Length</u>	<u>Wattage</u>
34	ETC	Parnels		575
1	ETC	Source 4	5 degree	750
31	ETC	Source 4	36 degree	750
25	ETC	Source 4	26 degree	750
13	ETC	Source 4	19 degree	750
19	ETC	Source 4	10 degree	750
21	ETC	Source 4Luster + Light	Cyc lens	(3 rd electric, ground row)
18	ETC	D40 Vivid		
18	ETC		35 degree	
18	ETC		45 degree	
2	Robert Julliat-Manon	Follow Spots		1200 (Lighting Booth)

2. **Connectors:** 3 pin, 20 amp grounded

3. Cables/Adapters:

- a. 2fers - 11; 3fers - 4
- b. 5' - 4'; 10' - 3; 15' - 4; 25' - 4; 50' - 1
- c. Adapters: Some

M. LIGHTING POSITIONS

1. On Stage:

- a. 12 TC Pearl work lights
- b. 18 D-40 downlights semi-permanently hung equally on 3 electrics
- c. 3 Electrics - 119 dimmer/circuits, 22 non dims - All fly in 4' from stage
 - 1st Electric - (24 dimmer/circuits + 5 Non-dims) Line 3 + 2'6"
 - 2nd Electric - (20 dimmer/circuits + 5 Non-dims) Line 14 + 11'2"
 - 3rd/4th Truss Electric - (36 dimmer/circuits + 5 Non-dims) Line 26 + 21'
- d. Walls:
 - Total 4: 2 DSR & DSL Proscenium, 2 Mid SR & SL - (each 6 dimmer/circuits + 1 non-dim)
 - Total 2: USR & USL Back Wall (each (8 dimmer/circuits + 1 non-dim)

2. Front of House: Total 22 Circuits - (No instrument is permanently mounted)

- a. Near Catwalk: (20 dimmer/ circuits + 4 Non-dims) Over 1st row of seats
- b. Far Catwalk: (18 dimmer circuits + 2 Non-dims) Over 13th row of seats
- c. No Balcony Rail /Box Booms

N. AUDIO

Audio & Video Production Systems (Attachment 4)

- a. Production Audio
- b. Production Intercom
- c. Production Video

NOTE: For Audio & Video System drawings contact: ocp@ogdensburgk12.org

(RENOVATED 2014-15)

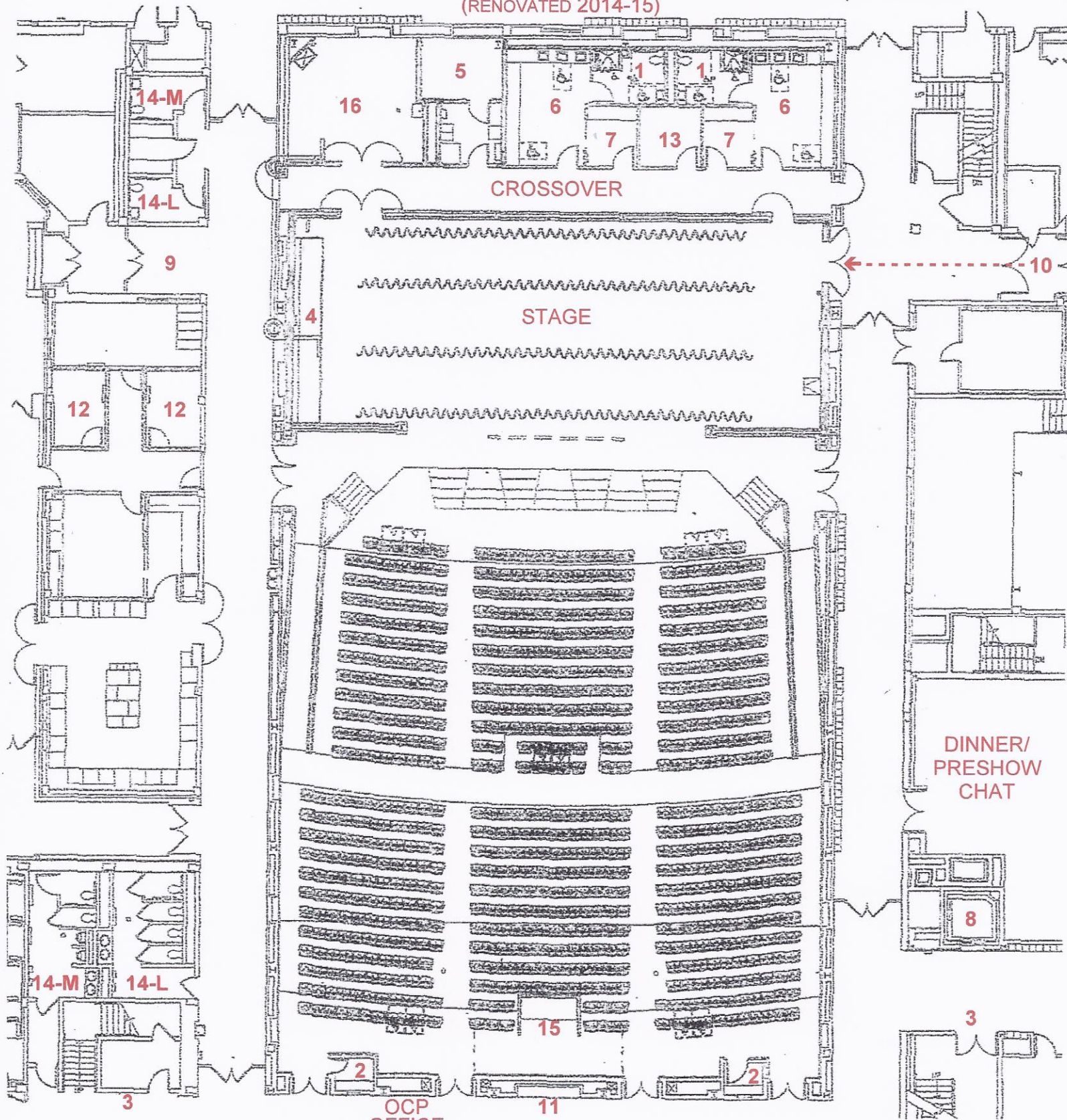

- 1-BATHROOMS
- 2-BOX OFFICES
- 3-CONCESSIONS
- 4-COUNTERWEIGHT SYSTEM
- 5-DIMMER/ELECTRIC
- 6-DRESSING ROOMS [10-12 PEOPLE]
- 7-DRESSING ROOMS [2-3 PEOPLE]
- 8-ELEVATOR
- 9-GREEN ROOM
- 10-LOADING DOOR
- 11-MERCHANDISE/SALES
- 12-POTENTIAL DRESSING ROOMS
- 13-PRODUCTION OFFICE [POTENTIAL DRESSING ROOM]
- 14-RESTROOMS [L/M]
- 15-SOUND BOARD [INCLUDES 12'X12' AREA OF POTENTIAL SOUND/LIGHT SPACE]
- 16-WORKROOM/LAUNDRY

OGDENSBURG FREE ACADEMY AUDITORIUM STAGE RIGGING SYSTEM

STAGE RIGGING

28 Each	1,300 lb gross capacity, six (6) line, single purchase manual counterweight linesets (Live load capacity 1,150 lb)
2 Each	2,300 lb gross capacity, six (6) line motorized counterweight assist stage electrics equipped with pantograph style lighting cable handing system and stage lighting distribution strip. Dual pipe batten arrangement.
1 Each	2,300 lb gross capacity, six (6) line motorized counterweight assist stage electric equipped with pantograph style lighting cable handing system and stage lighting distribution strip. Custom triangular truss serves as the 3 rd electric and 4 th "Cyc Electric".
2 Each	Dead hung Side Tab Battens 20'-0" long with Walk-Along drapery track.
12,400 lb	6" wide x 2" thick flame cut steel counterweight
3,100 lb	6" wide x 1" thick flame cut steel counterweight

- System is underhung from roof steel. There is no walkable gridiron.
- Linesets are spaced 8" c/c typical. See rigging and drapery schedule for lineset locations.
- Low trim 4'-0" off stage floor, high trim 46'-3" off stage floor
- All standard pipe battens are 1 1/2" ID Schedule 40 black iron pipe (1.9" OD), 54'-0" long.
- 3rd Electric is a custom triangular truss assembly of 1.9" OD aluminum pipe.
- Locking rail is located stage right at stage floor level.
- System is provided with a loading gallery. A Fall Protection System is provided at the loading gallery and harness use is required by all persons loading or unloading the counterweight arbors.

STAGE DRAPERIES

<u>Description</u>	<u>Qty</u>	<u>Width</u>	<u>Height</u>	<u>Fullness</u>	<u>Fabric Type</u>	<u>Color</u>
Main Curtain	2	27'-0"	22'-0"	100%	25 oz IFR Velour	Ink Blue
Leg Panels	6	20'-0"	22'-0"	Flat	25 oz IFR Velour	Black
Border Panels	4	54'-0"	8'-0"	Flat	25 oz IFR Velour	Black
Traveler Panels	4	27'-0"	22'-0"	Flat	25 oz IFR Velour	Black
Cyclorama	1	50'-0"	22'-0"	Flat	Seamless FR Cotton	White
Side Tabs	6	6'-0"	22'-0"	50%	25 oz IFR Velour	Black
Black Scrim	1	50'-0"	22'-0"	Flat	Seamless FR Cotton Sharkstooth	Black
White Scrim	1	50'-0"	22'-0"	Flat	Seamless FR Cotton Sharkstooth	White

OGDENSBURG FREE ACADEMY AUDITORIUM STAGE RIGGING SYSTEM

STAGE DRAPERY TRACKS

Main Curtain – ADC Series 280 bi-parting track, 54'-0" long overall, 3'-0" center overlap*

Travelers (2) – ADC Series 280 bi-parting track, 54'-0" long overall, 3'-0" center overlap*

Legs (3 Pair) – ADC Series 280 walk-along track, 20'-0" long

Side Tabs (2) – ADC Series 280 walk-along track, 20'-0" long

* All bi-parting tracks operate manually from stage right.

OTHER NOTES

- Manual counterweight sets may be stripped of draperies and tracks if required.
- The three (3) stage electrics are equipped with permanently mounted stage lighting distribution strips and pantograph stage lighting cable handling systems. While the stage lighting fixtures themselves may be removed, the distribution strip and cable handling system cannot be removed.
- Overhead roof beams are available for rigging of chain hoists, subject to the review and approval of loads by the venue's structural engineer.

This information is current as of May 2015 and is subject to change without notice. Please inform us if you have specific requirements.

OGDENSBURG FREE ACADEMY AUDITORIUM STAGE RIGGING SYSTEM

LINESET SCHEDULE					
SET NO.	DIST. FROM DATUM	DESIGNATION	RIGGING TYPE	CAPACITY	NOTES
1	0'-6"	MAIN CURTAIN	MANUAL CWT	1,300 LB	BI-PARTING TRACK, OPERATION STAGE RIGHT
2	1'-2"	1ST BORDER	MANUAL CWT	1,300 LB	
3	2'-6"	1ST ELECTRIC	MOTORIZED	2,300 LB	DUAL BATTENS, PANTOGRAPH CABLE HANDLING
4	3'-10"	1ST LEGS	MANUAL CWT	1,300 LB	ON (2) 20'-0" WALK-ALONG TRACKS
5	4'-6"	UTILITY/PROJ SCREEN	MANUAL CWT	1,300 LB	
6	5'-2"	UTILITY	MANUAL CWT	1,300 LB	
7	5'-10"	UTILITY	MANUAL CWT	1,300 LB	
8	6'-6"	UTILITY	MANUAL CWT	1,300 LB	
9	7'-2"	UTILITY	MANUAL CWT	1,300 LB	
10	7'-10"	UTILITY	MANUAL CWT	1,300 LB	
11	8'-6"	2ND BORDER	MANUAL CWT	1,300 LB	
12	9'-2"	2ND LEGS	MANUAL CWT	1,300 LB	ON (2) 20'-0" WALK-ALONG TRACKS
13	9'-10"	UTILITY	MANUAL CWT	1,300 LB	
14	11'-2"	2ND ELECTRIC	MOTORIZED	2,300 LB	DUAL BATTENS, PANTOGRAPH CABLE HANDLING
15	12'-6"	UTILITY	MANUAL CWT	1,300 LB	
16	13'-2"	3RD BORDER	MANUAL CWT	1,300 LB	
17	13'-10"	MIDSTAGE TRAVELER	MANUAL CWT	1,300 LB	BI-PARTING TRACK, OPERATION STAGE RIGHT
18	14'-6"	UTILITY	MANUAL CWT	1,300 LB	
19	15'-2"	UTILITY	MANUAL CWT	1,300 LB	
20	15'-10"	UTILITY	MANUAL CWT	1,300 LB	
21	16'-6"	UTILITY	MANUAL CWT	1,300 LB	
22	17'-2"	4TH BORDER	MANUAL CWT	1,300 LB	
23	17'-10"	3RD LEGS	MANUAL CWT	1,300 LB	ON (2) 20'-0" WALK-ALONG TRACKS
24	18'-8"	UTILITY	MANUAL CWT	1,300 LB	
25	19'-2"	UTILITY	MANUAL CWT	1,300 LB	MULED
26	21'-0"	3RD ELECTRIC	MOTORIZED	2,300 LB	TRI-TRUSS, PANTOGRAPH CABLE HANDLING
27	23'-8"	UTILITY	MANUAL CWT	1,300 LB	MULED
28	24'-8"	UTILITY	MANUAL CWT	1,300 LB	MULED
29	25'-8"	REAR TRAVELER	MANUAL CWT	1,300 LB	MULED, BI-PARTING TRACK, OPERATION STAGE RIGHT
30	26'-8"	CYCLORAMA	MANUAL CWT	1,300 LB	MULED
31	27'-8"	UTILITY	MANUAL CWT	1,300 LB	MULED
SLT	28' FROM C/L	STAGE LEFT TABS	DEAD HUNG	1,000 LB	ON 20'-0" WALK-ALONG TRACK
SRT	28' FROM C/L	STAGE RIGHT TABS	DEAD HUNG	1,000 LB	ON 20'-0" WALK-ALONG TRACK

DIAGRAM 2

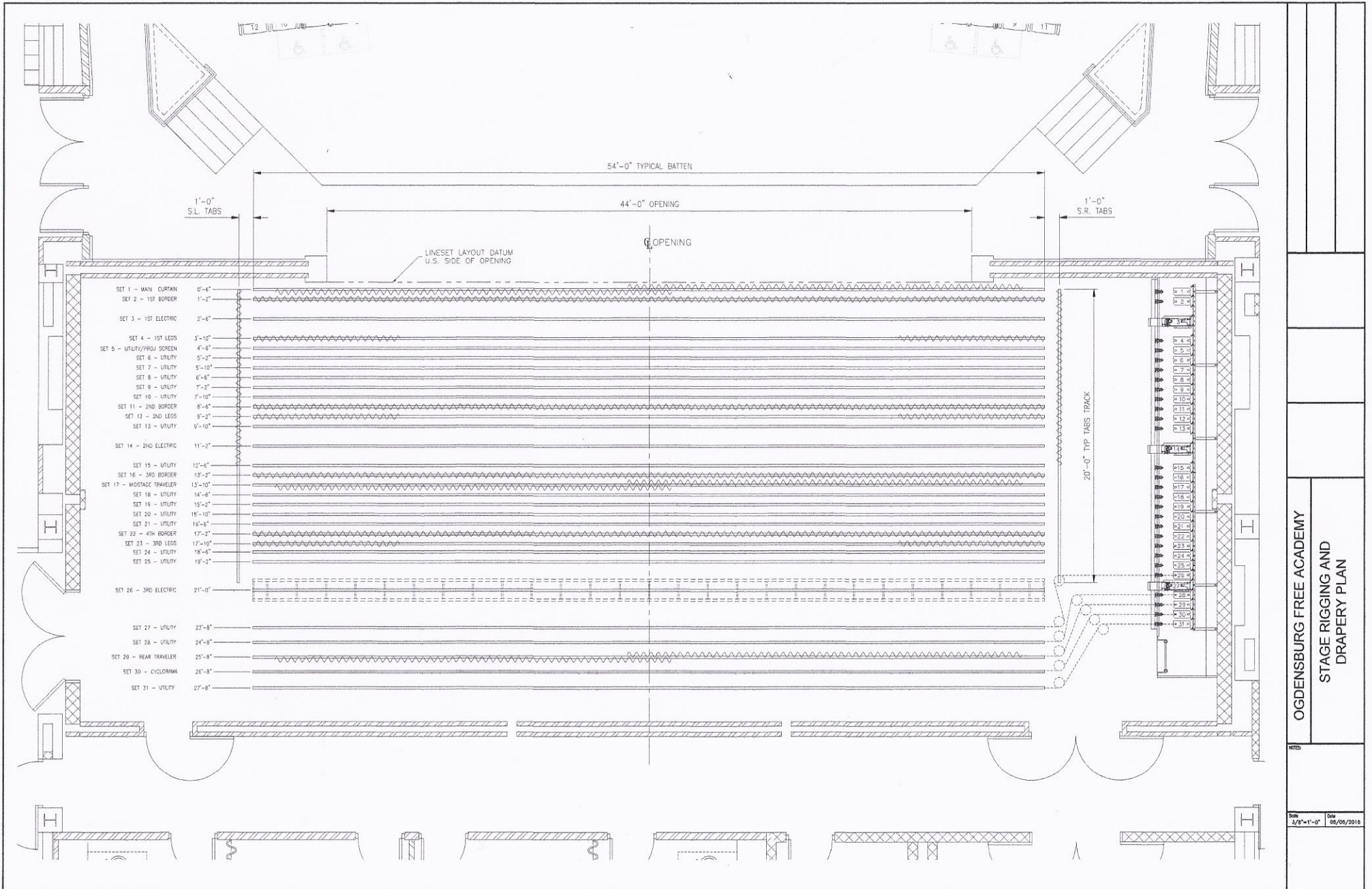

OGDENSBURG FREE ACADEMY
STAGE RIGGING AND
DRAPERY PLAN

DIAGRAM 3

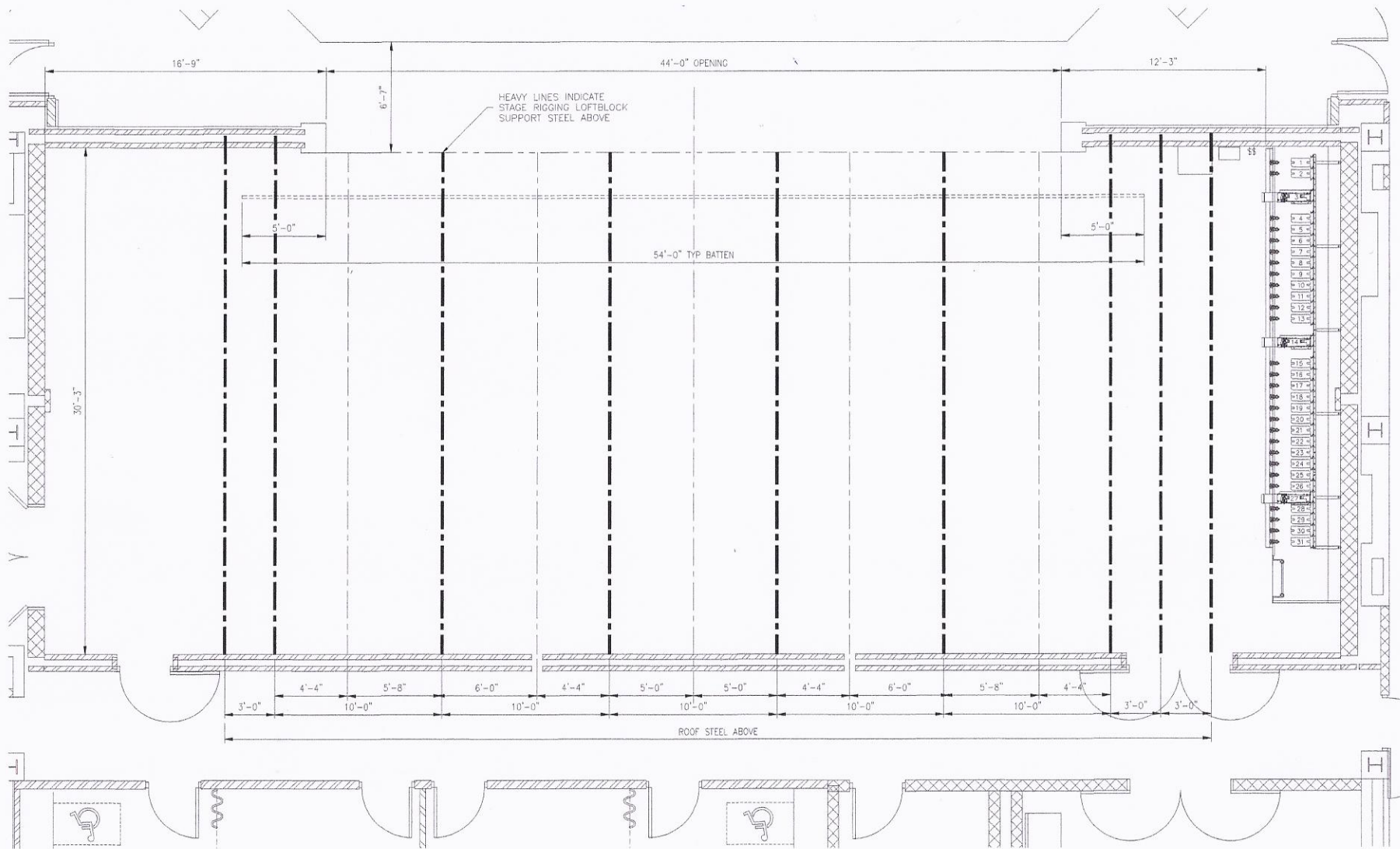

PROSCENIUM OPENING HEIGHT = 20'-0"
STAGE FLOOR TO UNDERSIDE OF RIGGING STEEL = 48'-9"

OGDENSBURG FREE ACADEMY
GENERAL STAGE PLAN

NOTE:
REV: 1/8"=1'-0" 10/1
05/05/2015

OGDENSBURG FREE ACADEMY AUDITORIUM STAGE LIGHTING SYSTEM

CONTROL

Board:.....ETC Ion 1500with 1536 Outputs/Parameters to Include:
 1 - 2x20 Fader Wing
 2 - Monitor -19' ELO Touchscreen – DVI

Lighting Control Locations:...Control Booth, Mid Stage Left (adjacent to Company Switch)
 Down Stage left @ Back Stage Control Panel, Auditorium Center
 @ Sound Control Position

Dimmers:.....ETC Sensor D20 (1 thru 158)
 ETC Sensor R20 (165 thru192)

Circuits:.....Dimming Circuits.....2P&G Stage Pin
 Relay Circuits.....L5-20 Twist Lock

DMX Network Locations:.....Far FOH Catwalk, Near FOH Catwalk, #1 Electric, #2 Electric, #3
 Electric, Down Stage Right, Mid Stage Right, Up Stage Right,
 Down Stage Left, Mid Stage Left, Up Stage Left. Each location is
 equipped with a N3T2G-2F - Portable (Touring) ETC Net3 Only
 Two Port Output Gateway.

<u>FIXTURE INVENTORY</u>	<u>Qty</u>	<u>Fixture</u>	<u>Wattage</u>
Ellipsoidal Spotlight:.....	1	ETC 419 - 5° Source Four.....	750
	19	ETC 419 - 10° Source Four.....	750
	13	ETC 419 - 19° Source Four.....	750
	25	ETC 419 - 26° Source Four.....	750
	31	ETC 419 - 36° Source Four.....	750
PAR:.....	4	ETC PAR EA Front of house work light	750
LED PAR:.....	18	ETC D40 VIVID	
	18	35° Round Lens in frame	
	18	45° Round Lens in frame	
LED Work Light.....	12	ETC Pearl SL3 11" LED Fixture with 60° Horizontal Lens 10.5" 60° Vertical Lens 10.5"	
LED Ground Row and Cyc:....	21	ETC Luster+ Light engine body with Source four LED CYC Lens (11 pipe mount, 10 on weighted base)	
Follow Spot.....	2	Robert Juliat – Manon Follow spot	1200w-MSD

OGDENSBURG FREE ACADEMY AUDITORIUM STAGE LIGHTING SYSTEM

Accessories.....	10	S4 Drop-In Iris #2180
	10	Pattern Holder S4 A-Size #2150
	2	Gam Pattern 201 - French Doors
	2	Gam Pattern 204 - Shutters
	8	Gam Pattern 294 - Summer Leaves
	10	Gam Pattern 579 - Foliage Breakup 3

CIRCUITRY:

Far FOH Catwalk – Far Stage Right – Dimming Circuits 1-3
 Far FOH Catwalk – Stage Right - Dimming Circuits 4-7, Relay Circuit 165
 Far FOH Catwalk – Center - Dimming Circuits 8-11
 Far FOH Catwalk – Stage Left - Dimming Circuits 12-15, Relay Circuit 166
 Far FOH Catwalk – Far Stage Left – Dimming Circuits 16-18

Near FOH Catwalk – Far Stage Right – Dimming Circuits 19-22
 Near FOH Catwalk – Stage Right - Dimming Circuits 23-26, Relay Circuit 167-168
 Near FOH Catwalk – Center - Dimming Circuits 27-30
 Near FOH Catwalk – Stage Left - Dimming Circuits 31-34, Relay Circuit 169-170
 Near FOH Catwalk – Far Stage Left – Dimming Circuits 35-38

#1 Electric-Circuits numbers from stage right- Dimming Circuits 39-62, Relay Circuit 171 - 175
 #2 Electric-Circuits numbers from stage right- Dimming Circuits 63-82, Relay Circuit 176 - 180
 #3 Electric-Circuits numbers from stage right- Dimming Circuits 83-118, Relay Circuit 181 - 186
 (*Note: The #3 Electric is a custom triangular truss batten that acts as the both the #3 electric for stage lighting and as the #4 “Cyc electric”.)

On Stage Down Stage Right – Proscenium - Dimming Circuits 119-124, Relay Circuit 187
 On Stage Mid Stage Right – Wall - Dimming Circuits 125-130, Relay Circuit 188
 On Stage Up Stage Right – Rear Wall - Dimming Circuits 131-138, Relay Circuit 189

On Stage Down Stage Left - Proscenium - Dimming Circuits 139-144, Relay Circuit 190
 On stage Mid Stage Left – Wall - Dimming Circuits 145-150, Relay Circuit 191
 On Stage Up Stage Left – Rear Wall - Dimming Circuits 151-158, Relay Circuit 192

ADDITIONAL AVAILABLE POWER DISTRIBUTION

Company Switch.....PowerSafe Pro 400A Company Switch, Mid Stage Left Wall
 6 wire (double neutral) Cam-Lok output
 Terminals for bare lead tie-in
 LED phase indicators
 Shunt trip protection of connection chamber

This information is current as of May 2015 and is subject to change without notice. Please inform us if you have specific requirements.

OGDENSBURG FREE ACADEMY AUDITORIUM AUDIO AND VIDEO PRODUCTION SYSTEMS

NOTES

1. All equipment and systems listed below are current as of July 2015 and are subject to change without notice.
2. Not all portable equipment may be available. Please contact the Auditorium Manager for specific needs. Usage fees may apply.
3. A 200A Company Switch by ETC with isolation ground is available downstage left for use with user-supplied Audio and Video systems. Cam-lock connections.
4. User must supply or replace all expendable items (i.e. non-rechargeable batteries).
5. For complete system drawings (including signal path one-lines), contact Ogdensburg Free Academy's Auditorium Manager.

PRODUCTION AUDIO

Qty.	Manufacturer	Model	Description
1	360 Systems	DigiCart / EX	Sound EFX Quick Play with DCEM-RC-320 Remote
4	AKG	C430	Microphones
6	AKG	C5	Microphones
2	AKG	D112	Microphones
8	AKG	D40	Microphones
1	Bosch	Aegis UFLED	IR Illuminator
2	BSS	BLU-160	Signal Processor with Digital Audio Bus (See drawing E1-623 and E1-624, One-Lines, for card configurations)
1	BSS	BLU-BIB	Input Expander
1	BSS	BLU-GPX	GPIO Expander
1			2-Space Rackmounted Computer to operate Sennheiser Monitoring System, Riedel RockNet Software and Crestron X-Panel Software, mounted in AVER-01
1		Custom	Wireless Access Point
12		Custom	Adaptors placed as a kit in Drawer at FOH location (M-XLR to M-XLR, IL-19, XLR Ground Lifts, XLR "Y", etc...)
2			24-Port Managed POE Switch
1			48-Port Managed POE Switch
1			22" or larger Screen for Audio Console
1			Custom Connection device to join AES/EBU with HiQNet.
20			20 Foot 1/4" Instrument Patch Cables
1			Microphone Accessory Kit (Spare Clips, Mic mounting bridge for 2-mics on 1 stand, foam wind screens, etc...)
50			30 Foot Mic Cables
20			50 Foot Mic Cables
8			NL4 30 Foot Speaker Cables (Include 4 NL4 Couplers)

OGDENSBURG FREE ACADEMY AUDITORIUM AUDIO AND VIDEO PRODUCTION SYSTEMS

8			50 Foot Heavy Gauge Power Cables with Quad Boxes
4	Crown	CTS-2000-BLU	Amplifier with PIP-Blu Card
1	Crown	CTS-3000-BLU	Amplifier with PIP-Blu Card
1	Crown	DCI 4 1250N	Networkable Multi-Channel Amplifier
1	Crown	DCI 4 600N	Networkable Multi-Channel Amplifier
1	Crown	DCI 8 300N	Networkable Multi-Channel Amplifier
2	Crown	I-T 4x3500HD	Amplifier
1	DA-LITE	Fast Fold Truss 16:9 -	(13' 6" H x 24' W) Stage Screen To be hung from a stage batten
2	Denon	DBT-3313UDCIP	Blu-Ray Players
2	Denon	DN-700C	CD-Player
1	Denon	PMD-580	Media Recorder Player
6	JBL	AC18/26	Under-Balcony Compact 2-way Loudspeaker System with MTU-18 Bracket
3	JBL	AC26	Front-Fill Ultra Compact 2-Way Loudspeaker (With MTU-26 Bracket)
4	JBL	ASB7118	Under Stage Subwoofers
48	JBL	Control 26CT	Ceiling Speakers
4	JBL	Control 67PT	Pendant Speakers
4	JBL	EON510	Powered Stage/Auxiliary Monitors
4	JBL	STX812M	Stage Monitors
1	JBL	VT-4881ADP-DA	Left Cluster Subwoofer
1	JBL	VT-4881ADP-DA	Right Cluster Subwoofer
5	JBL	VT4886	Center Cluster Speakers
6	JBL	VT4886	Upper Balcony Speakers (2-Per Cluster)
1	JBL	VT4886-AF	Center Cluster Array Frame
3	JBL	VT-4886-UB1	Upper Balcony Speaker Brackets (Contractor to confirm hanging installation with these brackets)
8	JBL	VT-4887ADP-DA	Left Cluster Speakers
8	JBL	VT-4887ADP-DA	Right Cluster Speakers
1	JBL	VT4887-AF	Left Cluster Array Frame
1	JBL	VT4887-AF	Right Cluster Array Frame
1	Listen Technologies	LT-800 SYSTEM	Assistive Listening System
3	Middle Atlantic Products	UPS-1000R	Uninterruptible Power Supplies (Two are located in Console Rack & One in the Rocknet Portable Rack)
1	Middle Atlantic Products	UPS-2200R	Uninterruptible Power Supplies (Located in AVER-02)
1	Riedel	RN.343.VI	Soundcraft Console Interface Card
12	Riedel	RN.301.MI	8-Channel Input Module
3	Riedel	RN.302.LO	8-Channel Output Module
2	Sennheiser	A 3700	Active Omni-Directional Antennas
1	Sennheiser	ASA 1/NT	Active Antenna Splitter (With Rack Mount Kit)
40	Sennheiser	BA 2015	Rechargeable Batteries

OGDENSBURG FREE ACADEMY AUDITORIUM AUDIO AND VIDEO PRODUCTION SYSTEMS

32	Sennheiser	EK 2000	Bodypack Transmitter
16	Sennheiser	EM2050	Dual Wireless Microphone Receiver (For a total 32-Channels)
8	Sennheiser	HSP 2	Headset Microphones
4	Sennheiser	L 1039-10	Rack Mount Battery Chargers (10-Per for a total of 40) With Rack Mount Kit
40	Sennheiser	MKE2	Lav Microphones
4	Sennheiser	MKH 40-P48	Microphones
2	Sennheiser	MKH 8040	Microphones
8	Sennheiser	SKM 2000	Handheld Transmitter wit MMK965BK Element
8	Shure	BETA 57	Microphones
8	Shure	BETA 58	Microphones
2	Shure	BETA 58S	Microphones with Switch
2	SKB	3I-2015-MC24	Microphone Cases
1	SKB	3SKB-R10U20W	10-Space Rolling Rack for Rocknet Portable System (Can be used in front of the stage, the Band Room and the Choral Room for remote orchestra locations - Digital Snake)
1	Soundcraft	Vi1	Digital Console with 2-Power Supplies
1	ToteVision	LCD-842HD1	Rack Mount Video Monitor
36	Ultimate Support	LIVE-SB	Straight Mic Stands
4	Ultimate Support	MC-125	Studio Boom Stand on Casters
8	Ultimate Support	TOUR-RB-SHORT-T	Short Stands with Telescoping Booms
4	Ultimate Support	TS-100	Speaker Stands
24	Ultimate Support	ULTI-BOOM-TB	Telescoping Boom Arm
1	Whirlwind	Direct 4	Specialty 4-Channel Direct Box
4	Whirlwind	Director-JT	Direct Box
4	Whirlwind	SNK84XL100	100 Foot Stage Snakes (8 In / 4 Out)
6	Whirlwind	pcDI	PC & DVD Audio Direct Boxes (3-shown on one-Line drawings and 3-spare)

PRODUCTION INTERCOM

4-channel production intercom and audio program monitor speakers are located in all dressing rooms, the Band and Choral Rooms, Guest Production Office, follow spot locations in upper booth, Box Office, backstage left, backstage right, and lighting and AV control locations.

Qty.	Manufacturer	Model	Description
1	ClearCom	CC-300	Single Ear Headset
5	ClearCom	CC-400	Dual Ear Headset
1	ClearCom	CM-944	4-Channel Wireless Base Station (Includes Remote Antenna Transceiver)
5	ClearCom	CP-942A	4-Channel Wireless Belt Pack with 10- T-LP1 Batteries
6	ClearCom	HS-6	Handsets
4	ClearCom	KB-701	Single Channel Speaker Station (Include V-Box per unit)
1	ClearCom	MS-704	4-Channel Master Station
2	ClearCom	PT-7	PTT Handset

OGDENSBURG FREE ACADEMY AUDITORIUM AUDIO AND VIDEO PRODUCTION SYSTEMS

3	ClearCom	RM-704	4-Channel Remote Station
10	ClearCom	RS-701	Single Channel Belt Pack
4	ClearCom	RS-703	Two Channel Belt Pack
1	ClearCom	T-BC5A	5-Bay Battery Charger For Beltpacks
1	SKB	1SKB-R906U20	Lighting Console Operator's Intercom Rack (Can be used in booth or in house being patched in front of the stage)

PRODUCTION VIDEO (Monitors and Projection)

Qty.	Manufacturer	Model	Description
1	Bosch	Aegis UFLED	IR Illuminator
1	Bosch	Dinion HD 1080P HDR	IP Camera for Conductor on a, up to 6-foot, stand (Include a H-264 decoder)
2	Crestron	CEN-CI3-1	Single Card Interface (With: Two C3COM-3 RS232 Cards, 1-per unit and both with Rack Mount Kits)
1	Crestron	CP3	Control Processor
1	Crestron	DM-MD 16x16	Video Switcher (With: 2-DMC-HD Input Cards 1-DMC-DVI Input Card 7-DMC-C Input Cards 2-DMCO-2222 Output Modules) Contractor to also provide 2-rear racked DM-PSU-16 power supplies for POE
16	Crestron	DM-RMC-Scaler-C	Scaler
5	Crestron	DM-TX-201-C	Input Baluns
2	Crestron	TSW-1050-B-S	Touch Panels (provide One-Custom Rack mount solution and One-TSW-1050-TTK-B-S Table Top Kit)
4	Crown	CTS-2000-BLU	Amplifier with PIP-Blu Card
1	Crown	CTS-3000-BLU	Amplifier with PIP-Blu Card
1	Crown	DCI 4 1250N	Networkable Multi-Channel Amplifier
1	Crown	DCI 4 600N	Networkable Multi-Channel Amplifier
1	Crown	DCI 8 300N	Networkable Multi-Channel Amplifier
2	Crown	I-T 4x3500HD	Amplifier
1	DA-LITE	Fast Fold Truss 16:9 -	13'-6" H x 24'-0" W Stage Screen hung from a stage batten
2	Denon	DBT-3313UDCIP	Blu-Ray Players
7	NEC	V423	42" Displays - Shop, Dressing Rooms, Band Office and Choral Office
4	NEC	V552	55" Displays - Main Band and Choral Rooms, 2 each displays rolling stands for use backstage
2	NEC	V652	65" Display for Balcony Video Monitor to stage (Conductor Cam, Clock, etc..) Mounted to balcony face

OGDENSBURG FREE ACADEMY AUDITORIUM AUDIO AND VIDEO PRODUCTION SYSTEMS

1	Panasonic	PT-DW17KU w/ET- D75LE30 Lens	Balcony Projector
1	Vaddio	WallView CCU HD-20 CAT-5	Front of House Camera with Crestron rack mounted control